

NOTES:

1. REFER TO [VERSITRIM SNAP-ON CANTED FASCIA INSTRUCTION MANUAL](#) FOR STEP-BY-STEP INSTALLATION PROCEDURES.
2. WHEN METAL FASCIA BY OTHERS IS USED, FASTENER TYPE AND FASTENING FREQUENCY SHALL BE RECOMMENDED BY METAL EDGE MANUFACTURER.

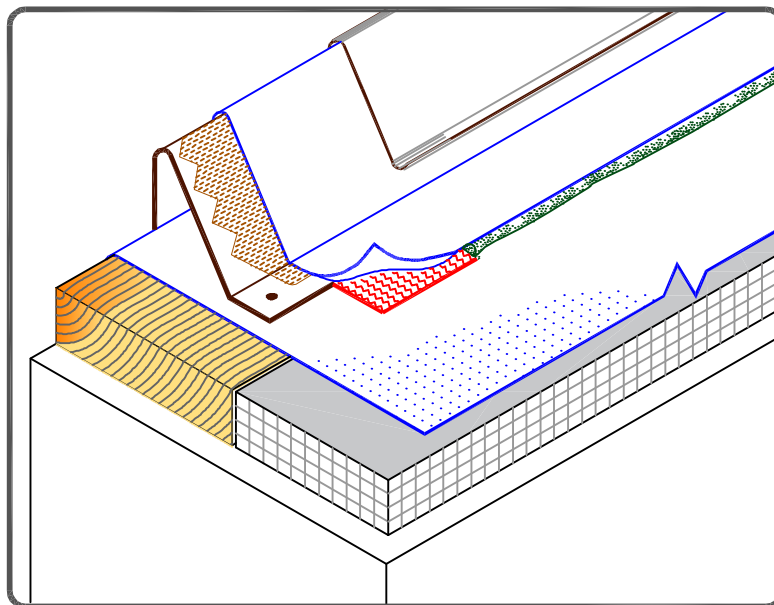

VERSITRIM SNAP-ON CANTED FASCIA

MAXIMUM WARRANTY: 30 YEARS

— PVC/PVC KEE MEMBRANE  
   APPROVED SUBSTRATE  
0 SEE NOTE  
 PS (PRESSURE SENSITIVE)

TPC (Thermoplastic Common Details)

TPC-1.4