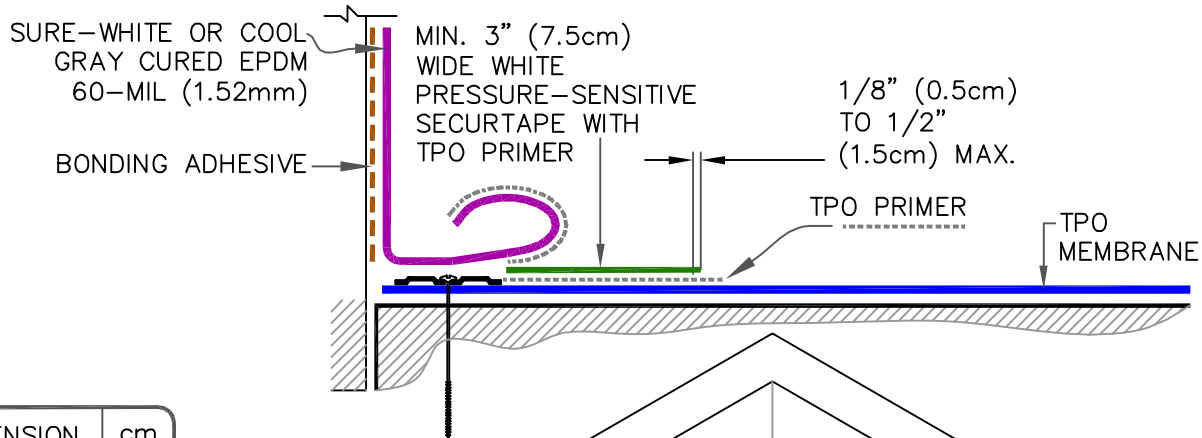

WARRANTY
REQUIREMENTS

20 YEAR WARRANTY

USE MIN 3" (7.5cm) WIDE
FACTORY-APPLIED TAPE ORMIN 3" (7.5cm) WIDE FIELD-APPLIED
SURE-WHITE SECURTAPE

25 OR 30 YEAR WARRANTY

REFER TO CARLISLE TYPICAL TPO DETAIL [U-2A](#).

DIMENSION	cm
(A) 3"	7.5

TPO WITH EPDM FLASHING

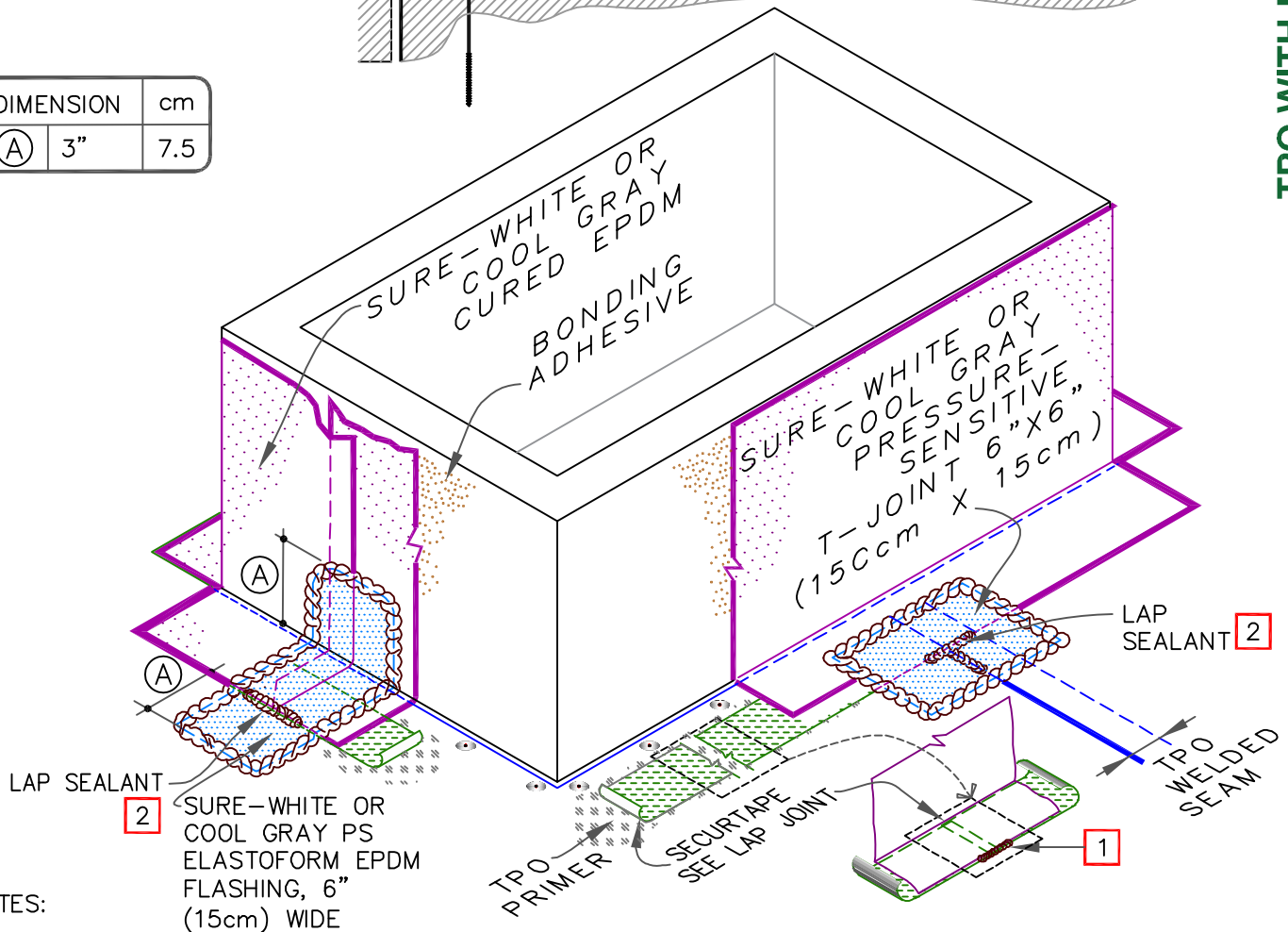

NOTES:

1. FIELD APPLIED SURE-WHITE OR COOL GRAY PRESSURE-SENSITIVE SEAM TAPE IS TO BE OVERLAPPED A MINIMUM OF 1" (2.5cm) AT THE ENDS OF EACH CUT PIECE. APPLY LAP SEALANT AT TAPE OVERLAPS 2" (5cm) IN BOTH DIRECTIONS.
2. APPLY CARLISLE WHITE LAP SEALANT OR GRAY UNIVERSAL SEALANT ALONG THE LEADING EDGE OF THE MEMBRANE SPLICE UNDER THE T-JOINT COVER, COVERING THE EXPOSED SPLICE TAPE 1/2" (1.5cm) IN ALL DIRECTIONS FROM THE SPLICE INTERSECTION.
3. INSTALL OUTSIDE CORNERS PER DETAIL [U-15ET](#) OR [U-15GT](#).



CURB/WALL WITH EPDM FLASHING

MAXIMUM WARRANTY: SEE WARRANTY REQUIREMENT ON TOP



DETAIL NO.

U-5AT