

NOTES:

- REGARDLESS OF WARRANTY/ WARRANTY WIND SPEEDS, MECHANICAL SECUREMENT MUST BE PROVIDED AT THE PERIMETER OF EACH ROOF LEVEL, ROOF SECTION, EXPANSION JOINT, CURB FLASHING, SKYLIGHT, INTERIOR WALL, PENTHOUSE, ETC., AT ANY INSIDE ANGLE CHANGE WHERE SLOPE EXCEEDS 2" IN ONE HORIZONTAL FOOT.
- SPLICES SHALL BE COMPLETED USING MINIMUM 3" (7.5cm) WIDE SecurTAPE/ PRIMER WITH EPDM MEMBRANE AND MINIMUM 1-1/2" (4cm) HOT AIR WELD WITH TPO/PVC.
- APPROXIMATELY 1/8" (0.5cm) DIAMETER BEAD OF CUT-EDGE SEALANT IS REQUIRED ON CUT EDGES OF REINFORCED TPO MEMBRANE.
- WHEN APPLYING AQUA BASE 120 BONDING ADHESIVE TO FLEECEBACK MEMBRANE ON THE VERTICAL WALL SUBSTRATE, APPLY A COAT OF AQUA BASE 120 ADHESIVE OR HYDROBOND TO THE FLEECE SIDE OF THE MEMBRANE AND ALLOW TO DRY. ONCE THE ADHESIVE ON THE FLEECE IS DRY, APPLY BONDING ADHESIVE AT THE COVERAGE RATE OF 60 S.F./GALLON FOR AQUA BASE 120 AND 100 S.F./GALLON FOR HYDROBOND TO THE WALL SUBSTRATE AND A SECOND COAT TO THE FLEECEBACK MEMBRANE.
- WHEN USING EPDM FB MEMBRANE, MINIMUM 6" (15cm) WIDE PRESSURE-SENSITIVE CURED COVER STRIP MUST BE CENTERED OVER THE MECHANICAL FASTENERS AND PLATES. WHEN USING TPO OR PVC FLEECEBACK MEMBRANE, MINIMUM 6" (15cm) WIDE REINFORCED THERMOPLASTIC MEMBRANE FLASHING SHALL BE CENTERED OVER THE MECHANICAL FASTENERS AND PLATES AND HEAT WELDED ON ALL SIDES AND TPO CAN USE PRESSURE-SENSITIVE SUREWHITE.

	<p>— FleeceBACK MEMBRANE</p> <p>— APPROVED ADHESIVE</p> <p>— APPROVED SUBSTRATE</p> <p>— SEE NOTE(S)</p>	<p>PARAPET/CURB WITH WATER BASED ADHESIVE</p> <p>MAXIMUM WARRANTY: 20 YEARS</p>	<p>DETAIL NO.</p> <p>FB-12C</p> <p>FLEECEBACK ADHERED</p>
--	--	---	---

CAUTION

REFER TO DETAIL [FB-12C](#) WHEN USING AQUA BASE 120 ADHESIVE OR HYDROBOND.

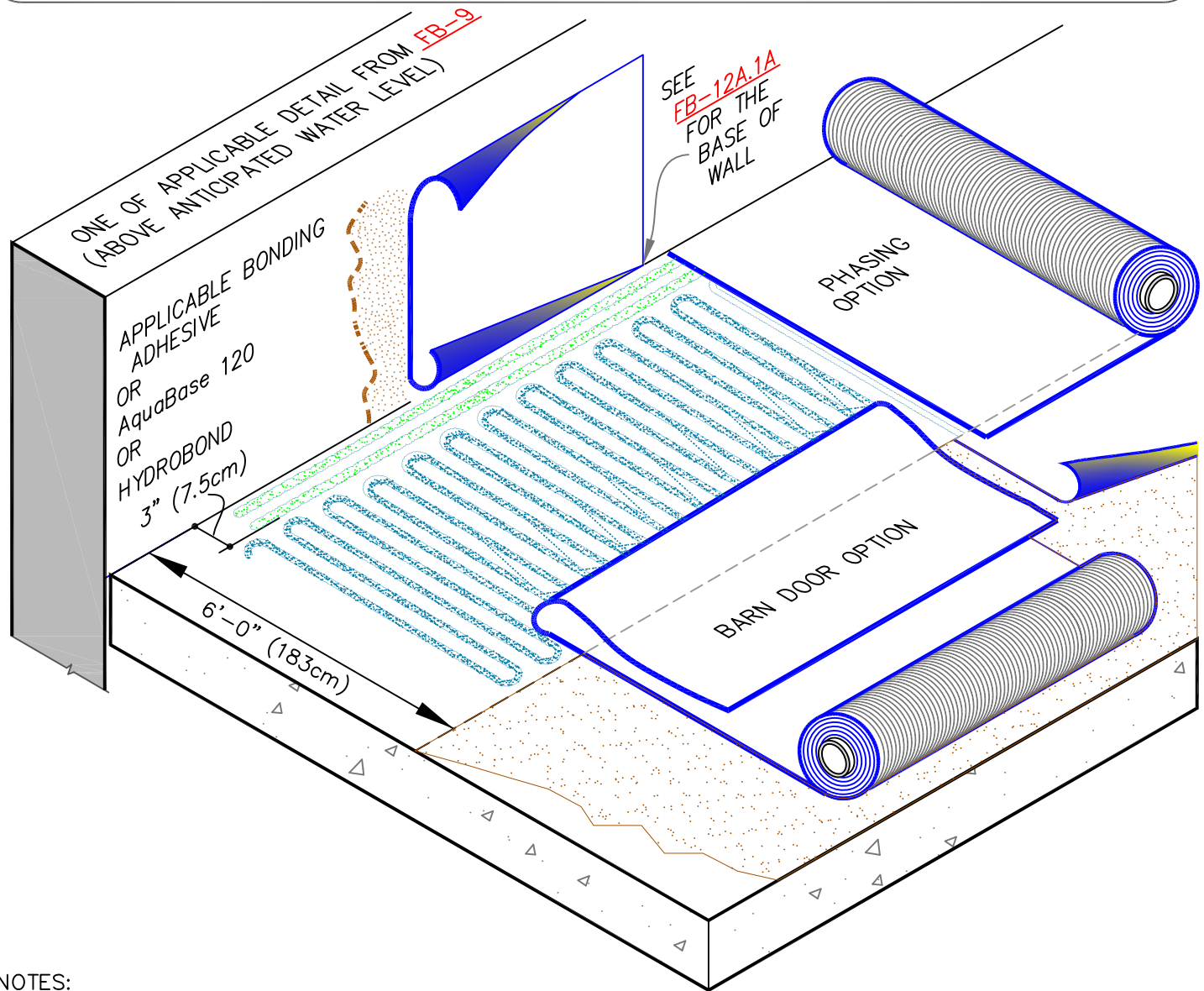

NOTES:

1. ADDITIONAL SECUREMENT IS REQUIRED FOR ANY ISNIDE ANGLE CHANGE WHEN SLOPE EXCEEDS 2" IN ONE HORIZONTAL FOOT.
2. SPLICES SHALL BE COMPLETED USING MINIMUM 3" (7.5cm) WIDE SecurTAPE/ PRIMER WITH EPDM MEMBRANE AND MINIMUM 1-1/2" (4cm) HOT AIR WELD WITH TPO/PVC.
3. APPROXIMATELY 1/8" (0.5cm) DIAMETER BEAD OF CUT-EDGE SEALANT IS REQUIRED ON CUT EDGES OF REINFORCED TPO MEMBRANE.
4. WHEN APPLYING AQUA BASE 120 BONDING ADHESIVE TO FLEECEBACK MEMBRANE ON THE VERTICAL WALL SUBSTRATE, APPLY A COAT OF AQUA BASE 120 ADHESIVE OR HYDROBOND TO THE FLEECE SIDE OF THE MEMBRANE AND ALLOW TO DRY. ONCE THE ADHESIVE ON THE FLEECE IS DRY, APPLY BONDING ADHESIVE AT THE COVERAGE RATE OF 60 S.F./GALLON FOR AQUA BASE 120 AND 100 S.F./GALLON FOR HYDROBOND TO THE WALL SUBSTRATE AND A SECOND COAT TO THE FLEECEBACK MEMBRANE.
5. FOR ALL EPDM SPLICE INTERSECTIONS, REFER TO [FB-2](#) DETAILS.

	<p>— FleeceBACK MEMBRANE</p> <p>— APPROVED ADHESIVE</p> <p>— APPROVED SUBSTRATE</p> <p>— SEE NOTE(S)</p>	<p>PARAPET/CURB-WATER BASED ADHESIVES W/ BEAD APPLIED FLEXIBLE FAST AT PERIMETERS- DIRECTLY OVER CONCRETE</p>		<p>DETAIL NO.</p> <p>FB-12C.1</p>
<p>MAXIMUM WARRANTY: 20 YEARS (90MPH)</p>			<p>FLEECEBACK ADHERED</p>	