

EXISTING WRINKLED BASE FLASHING

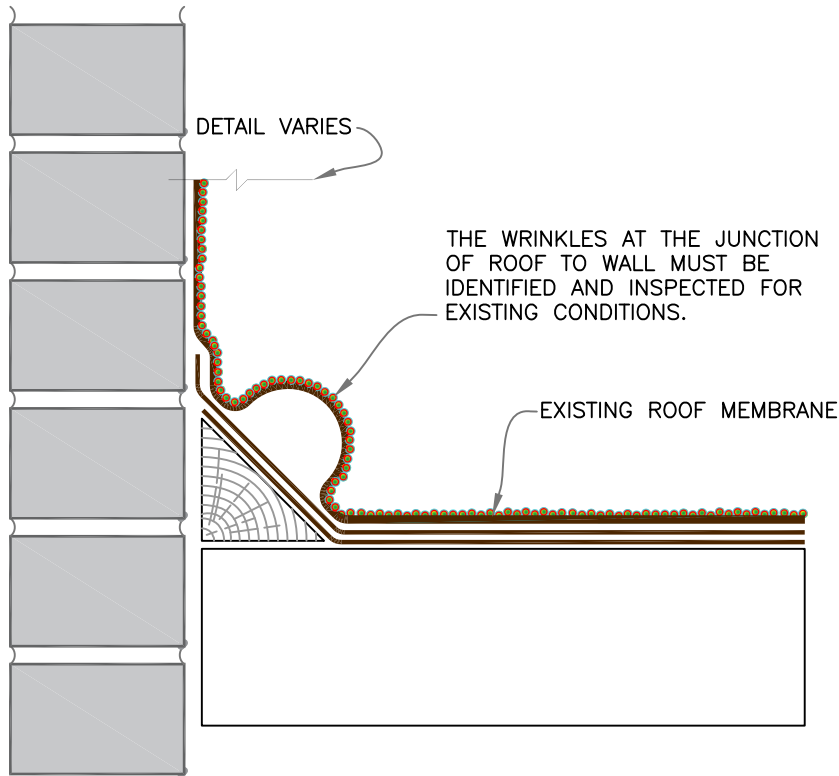

REPAIR & COATING

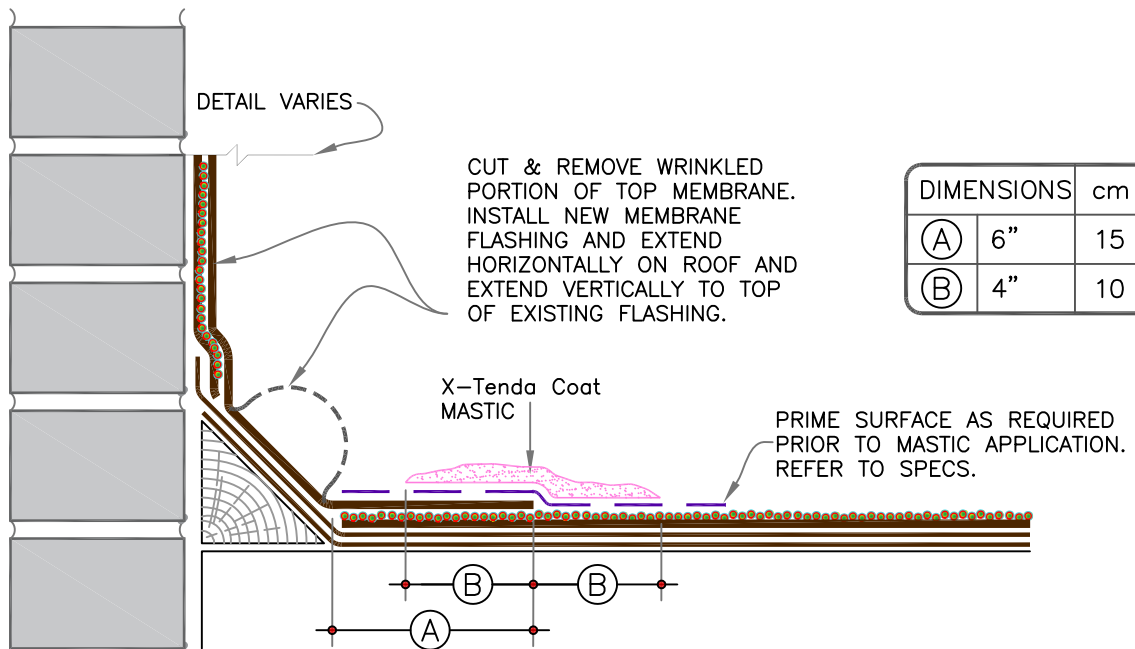

DIMENSIONS		cm	
(A)	6"	15	
(B)	4"	10	MIN.



- X-Tenda Coat COATING
- X-Tenda Coat PRIMER
- ~ REINFORCEMENT
- 0 NOTE(S)
- 0 X-Tenda Coat MASTIC

REPAIR:
WRINKLES AT ROOF-TO-WALL JUNCTION

NEW COATING ON EXISTING LOW SLOPE ROOFS

For additional information, refer to Specifications

X-Tenda Coat

A-8