

Anchor Products® HVAC Tie Down Kit Installation Guide

The Anchor Products HVAC Tie Down Kit provides enhanced securement for roof-mounted mechanical equipment. It can be used on new installations in high-wind areas or in retrofit applications to improve safety and comply with current code requirements.

This installation guide is intended for use by experienced Authorized Applicators. Each project must follow its specific specifications and engineering requirements to ensure proper securement and safety.

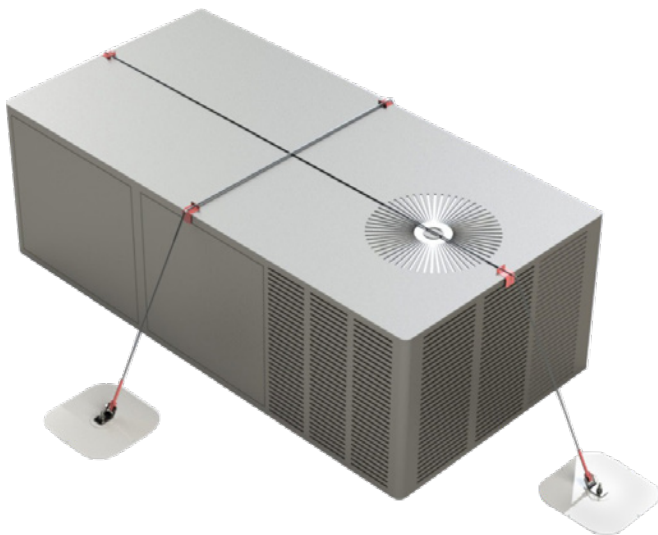

HVAC Tie Down Kit



STEP 1 – Install U-Anchors®: Installation begins by installing at least two U2400 Anchors (sold separately). Position them centered on the side or end of the HVAC unit, approximately 18" from the base, ensuring compliance with the engineered design. Refer to the applicable U-Anchor Installation Guide for detailed anchor installation instructions.

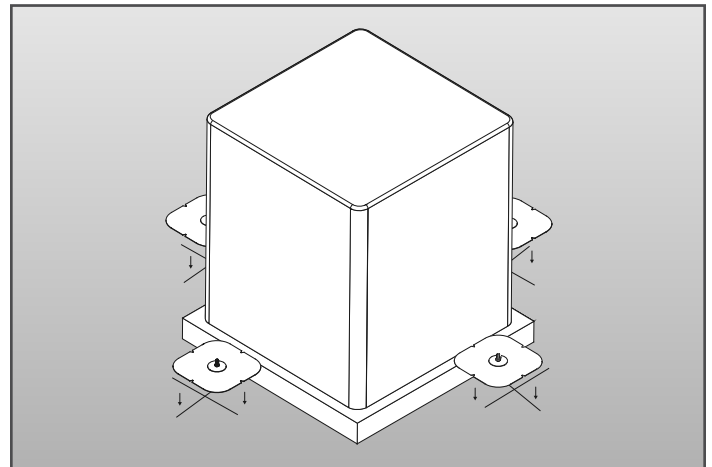

Anchor Products HVAC Tie Down Kit Installation Guide

STEP 2 – Secure the $\frac{30}{30}$ Bracket with Cable: Loosely secure the $\frac{30}{30}$ bracket with the attached cable onto the $\frac{3}{8}$ " bolt on a U2400 Anchor using the supplied $\frac{3}{8}$ " washer and $\frac{3}{8}$ " flange nut, aligning with the center bracket hole. Then extend the turnbuckle to allow for proper tensioning later.

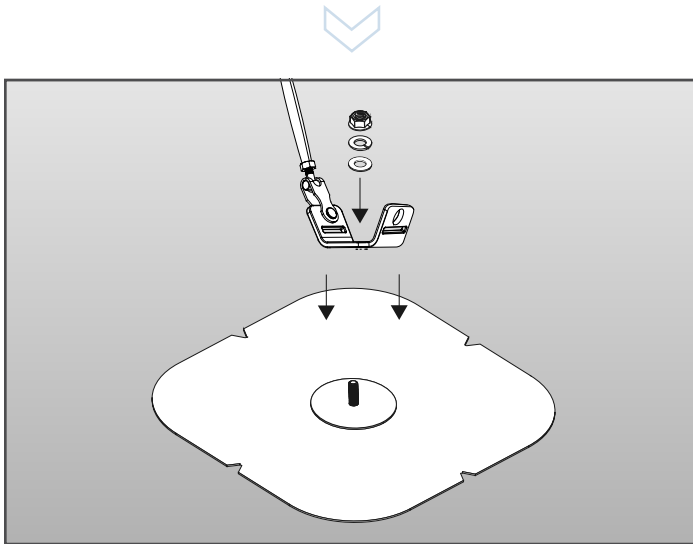

STEP 3 – Attach the Second Bracket: Loosely secure the remaining $\frac{30}{30}$ bracket to the opposite U2400 Anchor using the supplied washer and nut through the center hole of the bracket.

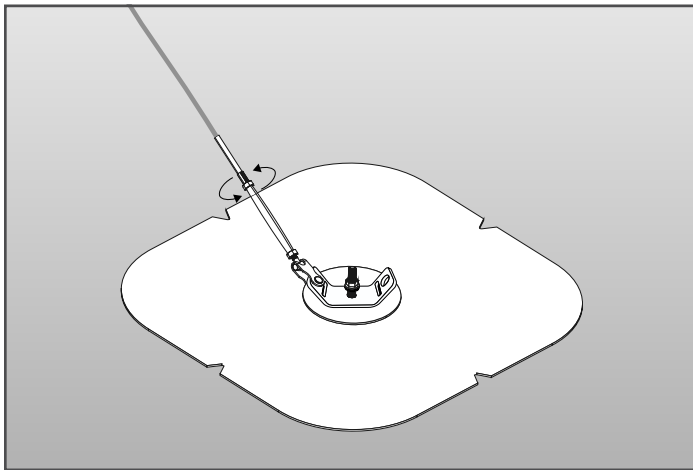
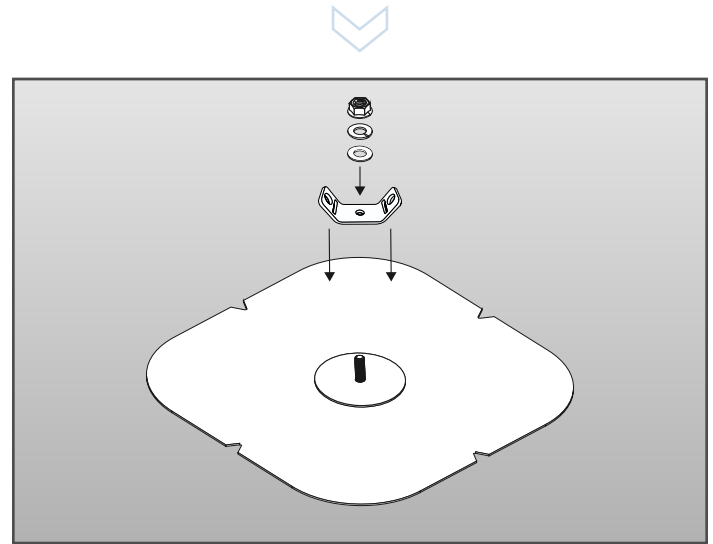

STEP 4 – Apply Corner Protectors: Align the supplied HVAC corner protectors in line with the two opposing U-Anchors on both sides of the equipment. Manually shape the protectors to follow the contour of the equipment's corner. Remove the adhesive backer and adhere the corner protector bracket into position.

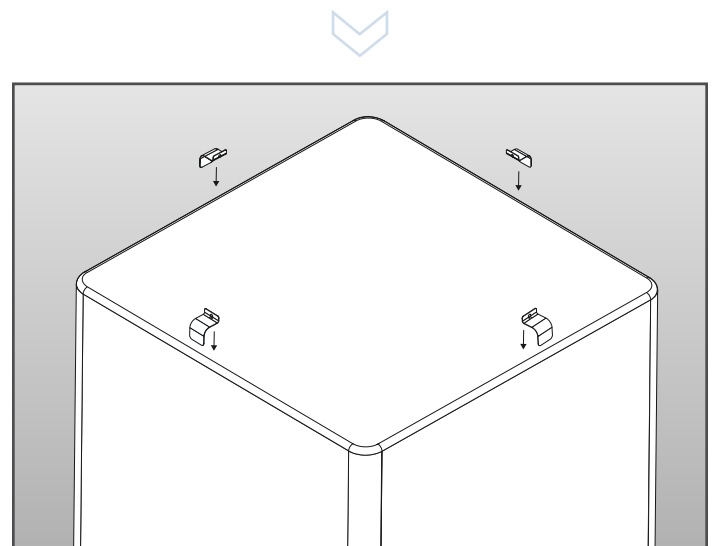

Anchor Products HVAC Tie Down Kit Installation Guide

STEP 5 – Thread the Wire Cable: Stretch the wire cable over the unit, inserting it through the eyelet on the first and second corner protector bracket.

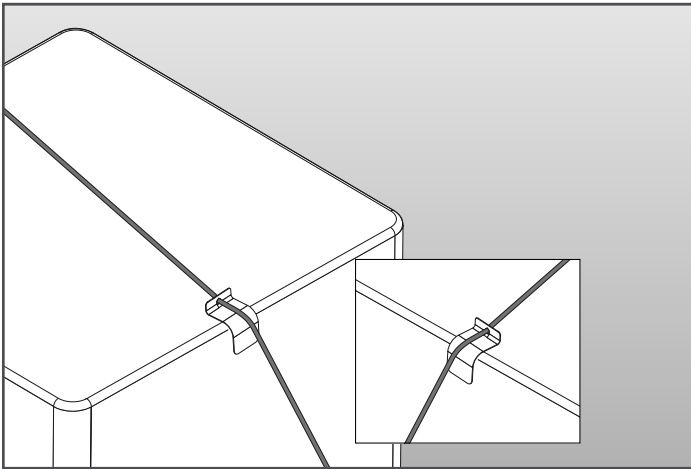

STEP 6 – Secure Wire Through Eyelet and Thimble: Insert thimble to 30/30 bracket eyelet on $30/30$ bracket. Thread the cable through the eyelet and thimble. Loop wire cable back on itself and remove slack by pulling it hand tight.

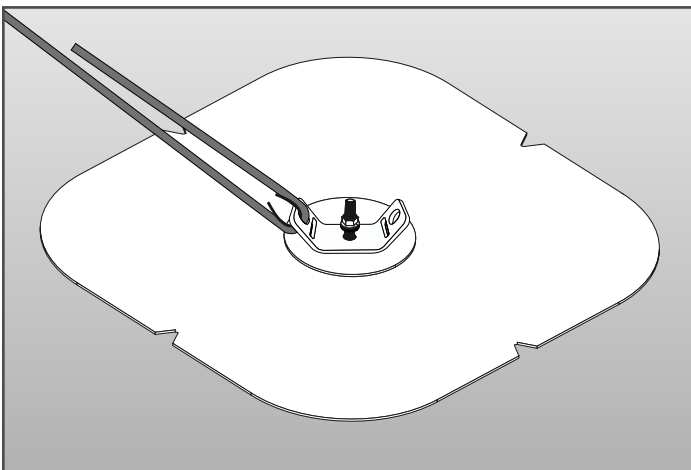

STEP 7 – Tighten the First Wire Cable Clamp: With the cable tight, secure the first wire cable clamp as close to the $30/30$ bracket as possible. Wire cable clamps should be installed with the “nut side” on the live end and the U-bar on the dead or cut end.

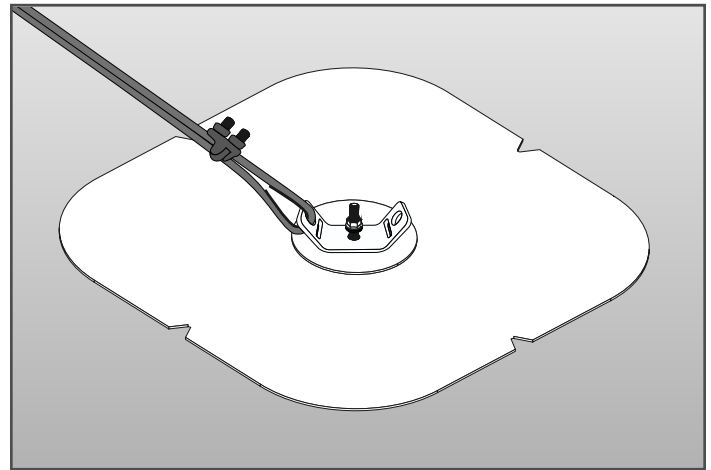

Anchor Products HVAC Tie Down Kit Installation Guide

STEP 8 – Install the Second Wire Cable Clamp: Repeat step 7, securing the second wire cable clamp. If the wire cable is $\frac{3}{16}$ " (the standard cable that comes with the HVAC Tie Down Kit), the second wire cable clamp should be positioned $3\frac{3}{4}$ " above the first cable clamp that was installed.

Note: If the HVAC Tie Down Kit was special ordered with thicker, $\frac{5}{16}$ " wire cable, the second wire cable clamp should be positioned $6\frac{1}{2}$ " above the first clamp.

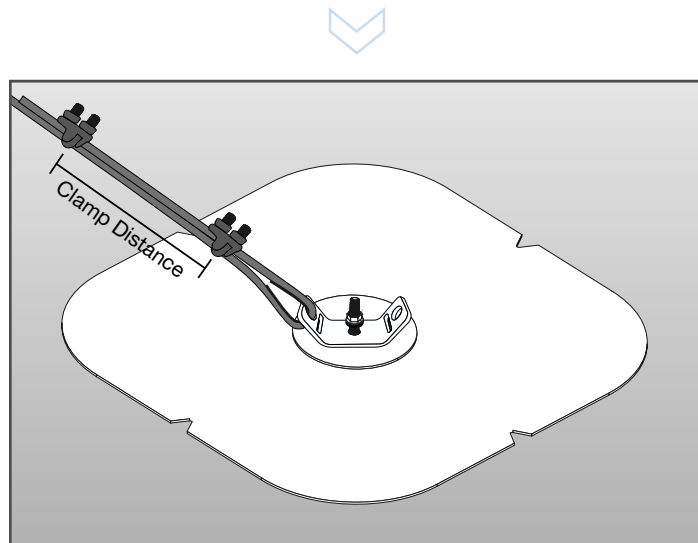

STEP 9 – Final Fastening & Adjustment: Using a calibrated torque wrench, tighten the nuts securing the $\frac{30}{32}$ brackets to the U-Anchors to 20 – 25 ft-lbs. Next, adjust the turnbuckle to the desired tension, then lock it in place by tightening the securing nuts on both ends.

