

NOTES:

1. WOOD NAILERS ARE INSTALLED AT SCUPPERS TO SECURE METAL SLEEVE AND MUST EXTEND PAST THE WIDTH OF METAL SLEEVE FLANGE.
2. METAL SCUPPER BOX MUST HAVE FOLDED FLANGE CORNERS FULLY COVERED BY OUTSIDE CORNER FLASHING.
3. WATER CUT-OFF MASTIC UNDER SCUPPER FLANGES MUST BE UNDER CONSTANT COMPRESSION.
4. SCUPPER FLANGES MUST BE TOTALLY COVERED BY NON-REINFORCED FLASHING WITH MINIMUM 2" (5cm) COVERAGE PAST NAIL HEAD.

WOOD NAILER (BY OTHERS) MUST BE PROPERLY SECURED TO DECK (SEE INSET BELOW). 1

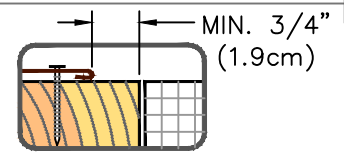

TPO PRE-MOLDED OUTSIDE CORNER FLASHING

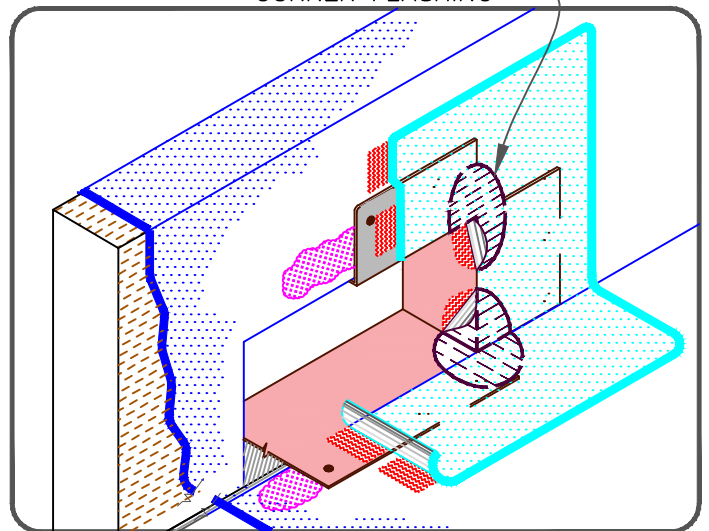

PREFABRICATED SCUPPER WITH TPO COATED METAL

MAXIMUM WARRANTY: 30 YEARS

	TPO MEMBRANE	PS (PRESSURE SENSITIVE)
	APPROVED SUBSTRATE	P&S (PEEL & STICK)
	SEE NOTE	QA (QUICK APPLIED)

THERMOPLASTIC ROOFING SYSTEM

TPC-18.1