

# SECUREDGE ONE COPING

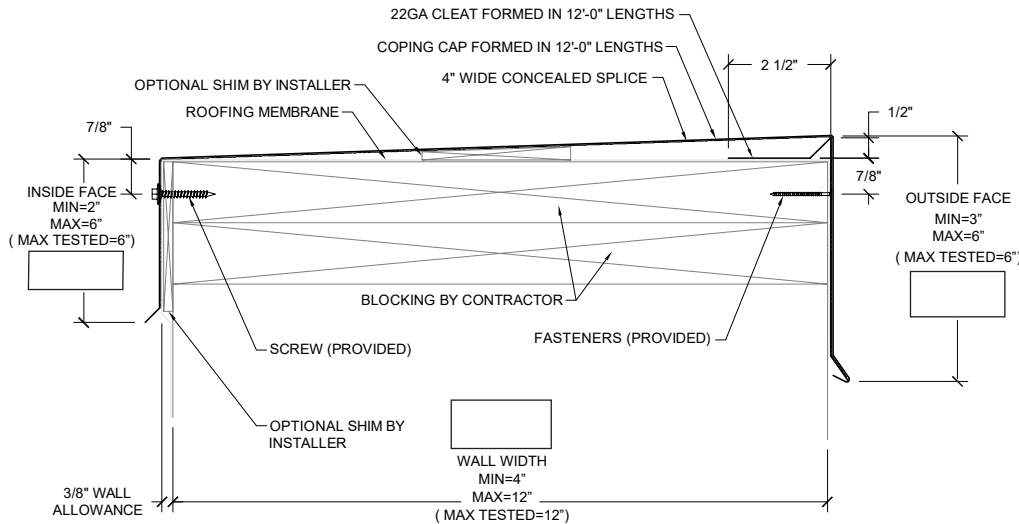

## VERSIONS

### TAPERED

SUBSTRATE CONDITION  
SHOWN ON DRAWING

### FLAT

SUBSTRATE CONDITION

### EXISTING SLOPE

SUBSTRATE CONDITION

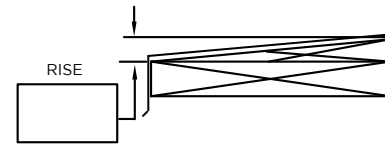

## \* NOTES

- Unless otherwise noted, fabrication of miters and accessories are furnished standard utilizing a non-penetrating quicklock joint, then factory sealed watertight.
- Welded accessories require a minimum material thickness of .050"
- For non-90 miters, see separate print approval
- Provided splice plates must be field caulked to prevent water entry
- Product should be installed per provided installation instructions
- ANSI/SPRI/FM 4435/ES-1 test pressures up to 61 psf (Horizontal) and 103 psf (Vertical)

## PROJECT INFO

Project Name: \_\_\_\_\_

Architect: \_\_\_\_\_

Roofing Contractor: \_\_\_\_\_

**Project Type:** \_\_\_\_\_

## APPROVALS\*

**ANSI/SPRI/FM 4435/ES-1**  
Test Pressures listed in notes

## MATERIAL\*

**Substrate:**  Wood  Masonry  Metal  
If substrate is not given, wood fasteners will be provided.

- |   |   |               |
|---|---|---------------|
| <input type="checkbox"/> 24 Ga. Galv. Steel | <input type="checkbox"/> .040" Aluminum | Color: _____  |
| <input type="checkbox"/> 22 Ga. Galv. Steel | <input type="checkbox"/> .050" Aluminum |               |
| <input type="checkbox"/> OTHER: _____       | <input type="checkbox"/> .063" Aluminum | Finish: _____ |

## QUANTITIES

- |   |
|---|
| _____ Right Endwall Flashing (Coping Version) |
| _____ Lineal Feet (12'-0" Lengths)            |
| _____ Outside Miter (90°)                     |
| _____ Inside Miter (90°)                      |
| _____ Right Endcaps                           |
| _____ Left Endcaps                            |
| _____ Left Endwall Flashing (Coping Version)  |
| _____ Outside Transition Miter                |
| _____ Inside Transition Miter                 |
| _____ Right Straight Transition Miter         |
| _____ Left Straight Transition Miter          |
- FILL OUT TRANSITION MITER MEASUREMENTS ON PAGE 2

## VERSIONS

- Tapered  
 Flat  
 Existing Slope

## ACCESSORY TYPE\*

- Quicklock (Default)  
 Welded (Surcharge)

By selecting this box you have verified and confirmed that dimensions, sizes, and quantities are correct. All products will be installed in strict accordance with printed instructions.

Date: \_\_\_\_\_

Customer Service  
866-458-3537  
(Metal-Era)

SHT# \_\_\_\_\_ of \_\_\_\_\_

DATE: **03/22/23**

DRN BY: **PL**

CKD BY: **MM**

DWG #: 15011-38012

REV: **C**

**STRAIGHT TRANSITION MITERS**

**FOR TAPERED AND FLAT VERSIONS (RIGHT)      FOR TAPERED AND FLAT VERSIONS (LEFT)**

**PLEASE INDICATE SLOPE BY CIRCLING APPROPRIATE OUTSIDE FACE.**

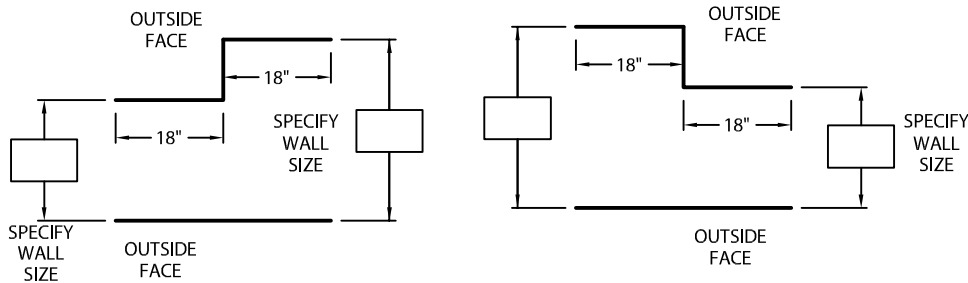

**EXISTING SLOPE VERSION (RIGHT)**

**FOR EXISTING SLOPE VERSION (LEFT)**

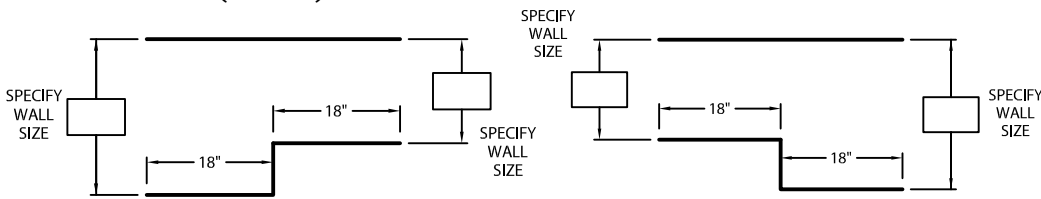

**PLEASE SPECIFY ELEVATION/SLOPE CONDITION**

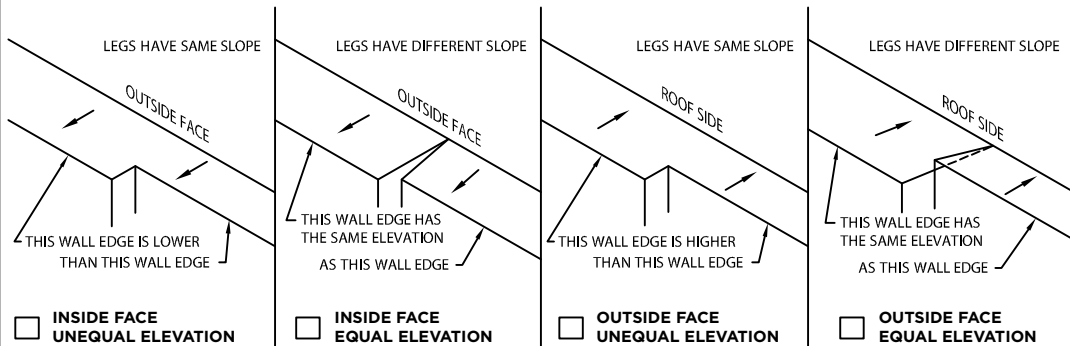

**TRANSITION MITERS**

**OUTSIDE**

**INSIDE**

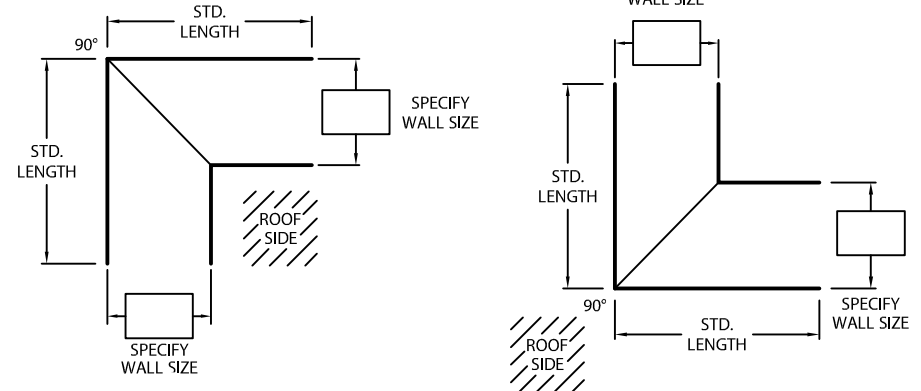

**STANDARD ACCESSORIES**

**OUTSIDE MITER**

**INSIDE MITER**

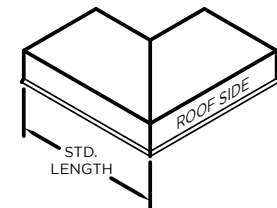
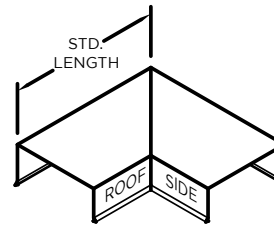

**ENDCAP (LEFT HAND SHOWN)**

**ENDWALL FLASHING COPING VERSION (RIGHT HAND SHOWN)**

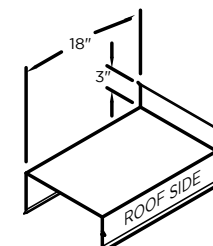
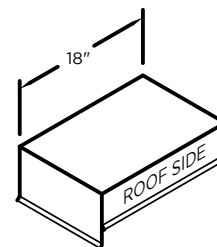

SHT# \_\_\_\_ of \_\_\_\_  
DATE: **03/22/23**  
DRN BY: **JJC**  
CKD BY: **MM**  
DWG #: 15011-38012  
REV: **C**