

VERSIFLEX™ PVC/KEE HP

Mechanically Attached Metal Retrofit

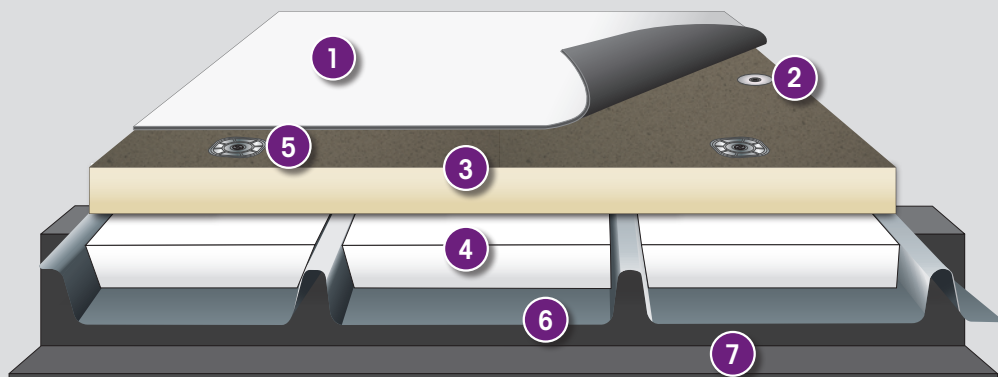

Typical Application

- 1 VersiFlex™ PVC or KEE HP Reinforced Membrane
- 2 Induction Welding Plates
- 3 Acceptable Insulation
- 4 Flute Fill Insulation
- 5 Insulation Fasteners and Plates
- 6 Existing Metal Roof
- 7 Structural Purlin

Colors	PVC: White, Gray, Tan, Light Gray and Slate Gray
	KEE HP: White, Gray, Tan, and Light Gray
Standard Thicknesses	50-, 60- and 80-mil
Standard Widths	40.5", 5', 81", 10'
Standard Lengths	50-mil – 100'
	60-mil – 100'
	80-mil – 75'

System Features and Benefits

- Adds insulating value
- Heat-weldable seams
- Roofing membrane is ENERGY STAR® qualified, CRRC rated, and can contribute to LEED® requirements
- Excellent wind uplift performance
- Industry-leading PVC and KEE HP membranes provide exceptional weatherability, durability, and long-term rooftop performance

VersiFlex PVC and KEE HP Membranes

Versico's VersiFlex PVC and KEE HP are high-performance, heat-weldable, single-ply membranes that provide outstanding long-term performance in new construction and re-roofing applications. VersiFlex KEE HP membranes utilize the highest grade of DuPont™ Elvaloy® to ensure the membrane can withstand extreme climatic conditions.

VersiFlex PVC Accessories

Versico also offers over a dozen prefabricated, in-stock accessories, and countless custom-order accessories. All carry a CFA (Certified Fabricated Accessory) stamp of approval, so you know they've been manufactured to the highest quality standards. Every Versico CFA saves you time and money during installation.

Metal Retrofit Mechanically Attached Roofing System Installation

PVC or KEE HP membrane is attached through the insulation (underlayment) to the purlins with Versico Purlin Fasteners and induction welding plates. Adjoining membrane sheets are hot-air welded together using an approved welder.

VERSIFLEX™ PVC/KEE HP



An Ideal Re-Roofing Solution

Convenience: Installs directly over existing metal roof eliminating costly and disruptive removal and replacement

Value: No adhesives provides ability to recycle membrane after its usable life

Performance: Highly reflective and chemically resistant roof system

Insulation

Flute-Fill Insulation: A key component of a metal retrofit system is the addition of custom-fit insulation between the standing seams of the metal roof panels. Versico offers both EPS (expanded polystyrene) and Polyiso flute-fill insulation that can be factory cut to fit between each metal panel. This insulation layer also adds R-value and can be loose-laid or adhered.

Additional Insulation: Once flute-fill insulation has been installed, additional insulation ranging from a ¼-inch cover board to several inches of polyiso insulation can be installed to create a smooth flat substrate for the membrane. Adding polyiso insulation and cover boards can add additional R-value to the system. Using a high-compressive strength polyiso cover board or gypsum cover board can also enhance impact resistance and fire resistance.

Membrane and System Strengths

- Economical to install over existing metal roofs
- Specially designed fastening system using induction welding plates anchors into the structural purlins (the strongest point of the roof) for optimum performance
- Easily installed over most aged metal roofs
- Heat-weldable seams provide a complete, monolithic membrane assembly
- VersiFlex PVC and KEE HP reinforced membranes are durable, puncture resistant, and ENERGY STAR qualified for cool roof designs

System Codes

- UL Class A, B, and Unlimited Slope ratings are available
- Meets FM Loss Prevention Data Sheet 1-31

For specific code approvals, refer to Versico's Code Approval Guide.

Warranty

Consult your Versico Authorized Contractor, Independent Sales Representative, or Distributor for associated warranty charges.

Versico's metal retrofit roof systems are backed by our industry leading Total System Warranty. Five to twenty year total system warranties are available with optional hail, puncture and reflectivity warranties available upon request.



	Mechanically Attached	Induction Welded
	Flutes of Existing Metal Roof are filled with an Acceptable Insulation	
Flute Filler Attached By	Insulation is loose-laid into flutes	
	Approved insulation is then laid over Flute Filler	
Insulation Attached By	Insulation is mechanically fastened into existing metal with Insultite Insulation Fastener or HPVX Fasteners	
Membrane Attached By	Purlin Fasteners and HPVX Plates are used to attach PVC or KEE HP membrane to existing purlins	Purlin Fasteners and Induction Welding Plates are used to attach PVC or KEE HP membrane to existing purlins

For more information, refer to VersiFlex specifications. UL Class A Ratings available.

For current code approvals and warranties, visit Versico's website or contact a design analyst..



A SINGLE SOURCE FOR SINGLE-PLY ROOFING

800.992.7663 • www.versico.com