

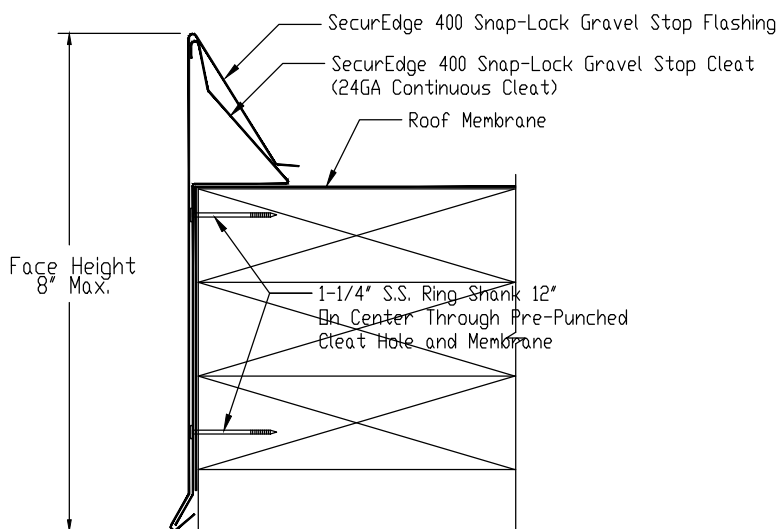

SYNTEC SYSTEMS

Installation Guide for SecurEdge 400 Snap-Lock Gravel Stop



NOTES:

- #1 - Isolate all metal parts from ACQ treated wood or other galvanically incompatible material with appropriate membrane material.
- #2 - Appliance attachments, such as lightning rods, signs, or antennae that penetrate the water seal, induce a galvanic reaction, or otherwise compromise the effectiveness of the roof edge system, shall be eliminated or isolated to prevent problems per section 8.0 if ANSI/SPRI ES-1. Appliances should also be isolated from, or not attached to, the roof edge system. Consult the lightning protection system manufacturer for specific attachment instructions.

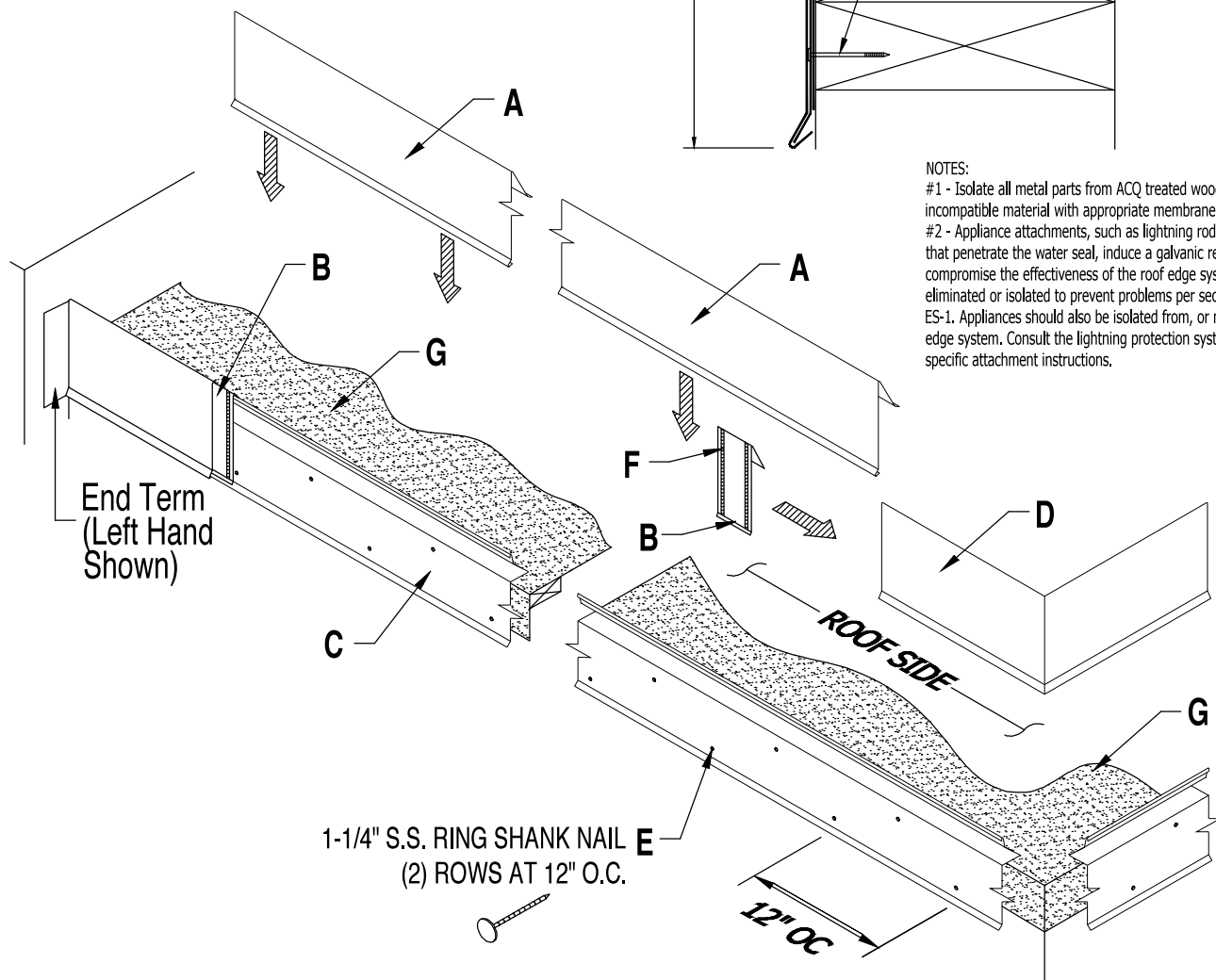

A. SecurEdge 400 Snap-Lock Gravel Stop Flashing

10'-0" Std. Lengths

B. SecurEdge 400 Snap-Lock Gravel Stop Splice Plate

6" Lengths

C. 24GA Steel Continuous Cleat

10'-0" Lengths

D. SecurEdge 400 Snap-Lock Gravel Stop Miter (Outside Corner Shown)

E. 1-1/4" S.S. Ring Shank Nail

at 12" o.c. (6" o.c. within 3'-0" of Corners)
(Included & Required)

F. Tube Sealant

G. Approved Roofing Membrane (By Installer)

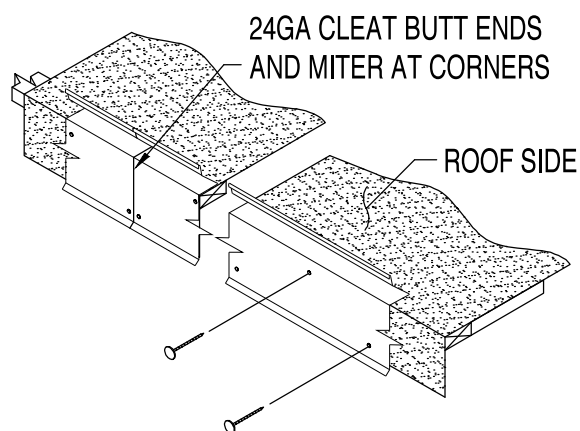

STEP 1 : Installing 24GA Galvanized Continuous Cleat

Place the roof side foot of the Cleat squarely over the roof membrane on the top edge of the wood nailing plate. Press cleats securely in position and nail through the pre-punched holes with 1-1/4" S.S. Ring Shank Nails provided. Apply a bead of Tube Sealant over butted Cleat ends. For Miter application, miter cut into corner as required to maintain a continuous Cleat line. Then nail at a min. 6" in each direction from the corner or closer at special conditions.

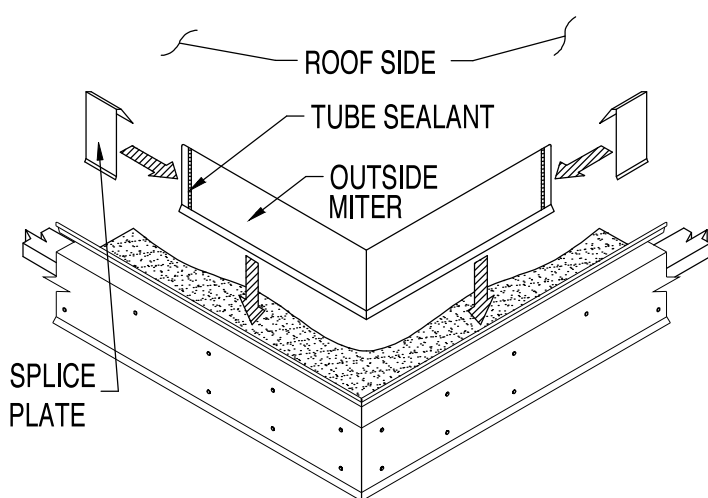

STEP 2 : Installing SecurEdge 400 Snap-Lock Gravel Stop Miters

Locate the Miters and Splice Plates for the appropriate corners. Apply a bead of Tube Sealant inside the Miter ends. Place a Splice Plate under each end of the Miter sections. Install the Miter by hooking the SecurEdge 400 Snap-Lock Gravel Stop Miter over the roof side kick up of the Cleat, and push down onto the lower kick of the Cleat.

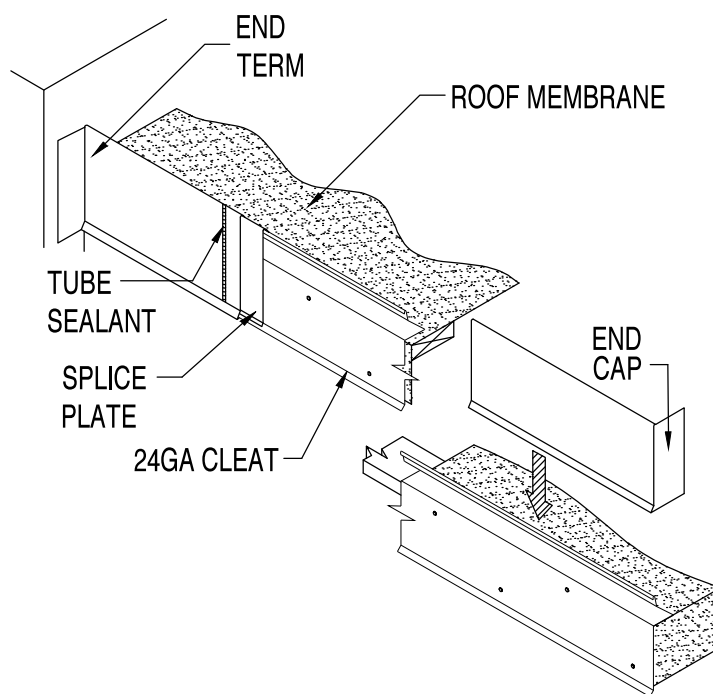

STEP 3 : Installing Gravel Stop End Caps and End Terms

Apply a bead of Tube Sealant inside End Cap or End Term and place a Splice Plate under each end of the End Cap or End Term. Install the SecurEdge 400 Snap-Lock Gravel Stop End Caps and End Terms by hooking the drip of the End Cap or End Term over the roof side kick up of the Cleat, and push down onto the lower kick of the Cleat.

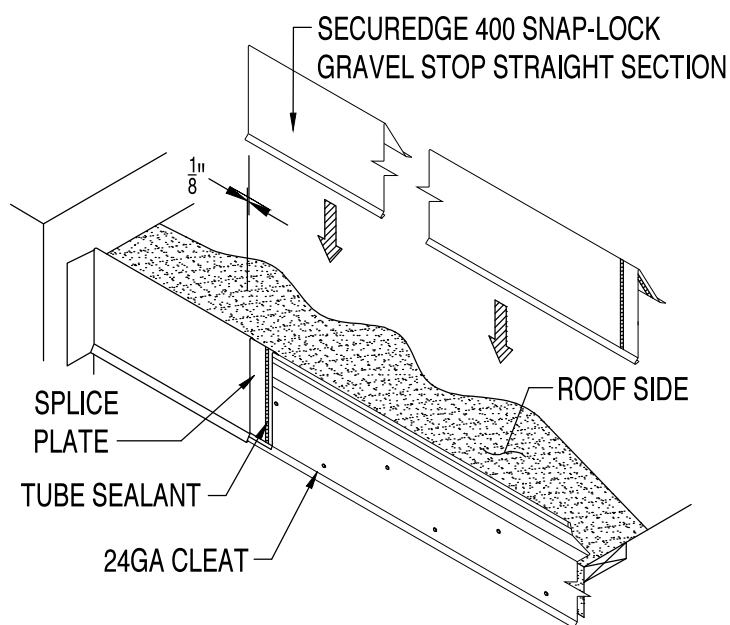

STEP 4 : Installing Gravel Stop Straight Lengths

Apply a bead of Tube Sealant onto the Splice Plate of the Miter, End Term, or End Cap. Install the SecurEdge 400 Snap-Lock Gravel Stop Flashing by hooking the flashing onto the roof side kick up of the Cleat and push down onto the lower kick out of the Cleat. **Allow 1/8" Gap between Gravel Stop lengths for thermal expansion.** Consider lengths of all straight pieces prior to cutting to avoid creating relatively short sections adjacent to one another. Note: There should be a Splice Plate at every joint.