

CAUTION

DETAIL NOT FOR USE ON 25-YEAR WARRANTY PROJECTS. ACCEPTABLE PIPE FLASHINGS SHALL CONFORM WITH VERSIFLEECE AC-8.1 OR REFER TO THERMOPLASTIC COMMON DETAILS.

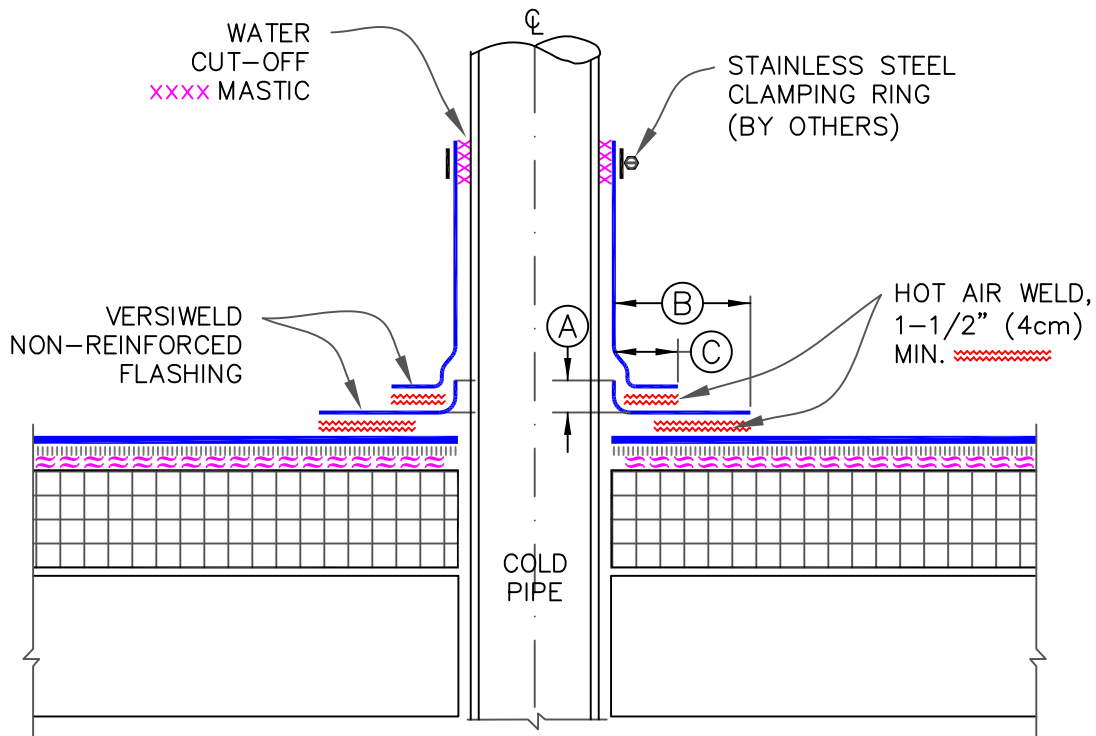

DIMENSIONS		cm	
(A)	1/2"	1.5	MIN.
(B)	1-1/2"	4	TO
	2"	5	
(C)	1"	2.5	MIN.

NOTES:

1. REMOVE ALL LEAD AND OTHER FLASHING BEFORE INSTALLING FIELD FABRICATED PIPE SEAL.
2. TEMPERATURE OF PIPE MUST NOT EXCEED 140°F (60°C) WHEN USING KEE HP AND 160°F (71°C) WHEN USING TPO FLASHING.
3. APPLY HEAT TO FLASHING AND FORM BY HAND PRIOR TO HOT AIR WELDING
4. MECHANICAL SECUREMENT IS REQUIRED AROUND ALL PIPES GREATER THAN 18" (46cm) IN DIAMETER.
5. REFER TO THERMOPLASTIC COMMON DETAILS FOR HOT STACK, STEEL TUBING & FLEXIBLE PENETRATIONS.



FIELD FABRICATED PIPE FLASHING

→ AC MEMBRANE OR KEE HP
 → ASPHALT/COLD APPLIED
 → APPROVED SUBSTRATE
 0 → SEE NOTE(S)

VERSIFLEECE AC OR KEE HP

AC-8.2