

SUSTAINABLE ROOFING SYSTEMS FOR PROPERTY MANAGEMENT



CARLISLE
SYNTEC SYSTEMS

CARLISLE SYNTEC SYSTEMS **IS ROOFING**

Carlisle revolutionized the commercial roofing industry 50 years ago with the introduction of its Sure-Seal® EPDM assemblies, and it continues that tradition of innovation today with the industry's widest variety of high-performance roofing systems. Carlisle offers its EPDM, TPO and PVC roof systems in a wide variety of full system assemblies to accommodate virtually any office building, shopping center, or distribution facility project.

UNDERSTANDING PROPERTY MANAGEMENT

Carlisle SynTec roof systems have been installed on shopping centers, office buildings, and distribution facilities throughout the U.S., covering more than one billion square feet. This wealth of experience has provided us with a clear understanding of the specialized design and construction challenges property managers face. We understand that a roofing project cannot be disruptive towards business within the building and is a major concern to property managers. Recognizing these concerns, Carlisle has developed unique, long-term solutions to meet the specific roofing needs of property managers.



CONTACT CARLISLE FOR ASSISTANCE

To learn more about how Carlisle SynTec Systems can help Property Managers or to discuss your next roofing project, contact Franc Trinchi at [215.361.8046](tel:215.361.8046) or email franc.trinchi@syntec.carlisle.com.

MEETING THE DEMANDS OF PROPERTY MANAGERS

Environmentally Preferred Product Options

- VOC- & solvent-free system adhesives
- Low-VOC products
- Energy-efficient materials & energy-saving design options
- Adhesive-free installations
- Recycling program for system divestment

Re-roofing and Retrofit Solutions for Minimized Operational Impacts

- Odor-free & low-odor installations
- Noise, vibration & sound mitigation solutions
- No open flames, propane torches or hot work permits required
- Easy repair & maintenance
- Direct recover options & adaptable designs avoid disruptions & shutdowns

Severe Weather Protection Enhancements with Single-source, Long-term Warranty Coverage

- Hail damage resistance
- High wind speed & uplift designs
- Puncture-resistant membranes
- Class A fire-rated assemblies & approvals
- Multiple-ply, durable assemblies



UNIQUE SOLUTIONS DESIGNED FOR PROPERTY MANAGEMENT

Carlisle SynTec Systems offers a versatile line of products, systems and services that provide the protection and performance required of an office building, shopping center, or distribution facility. This wide array of materials allows property managers to develop customized solutions for their specific and unique needs.

Proven Performance

- Carlisle's 50-year history of success & industry-leading innovation allows us to draw on best practices & internal evidence-based design
- Single-source warranty for all roof system components
- Designated product warranty reserve & financial strength
- Comprehensive code approvals & testing performance

Total System Protection

- Three single-ply assembly options – EPDM, TPO and PVC
- Thicker membranes, redundancy & patented FleeceBACK® technology
- Wind-, hail- & puncture-resistant enhancements available
- Insulation & coverboard options improve thermal performance & enhance rooftop durability
- Temporary roof systems provide installation flexibility
- Air/vapor retarders help prevent air & moisture migration

Service & Support

- RoofSense lifecycle analysis program calculates optimal insulation R-values & membrane colors
- Integrated Project Delivery (IPD) capabilities
- Industry's most knowledgeable Design Services department
- Nationwide network of factory-trained authorized applicators
- Technical Field Services maintain crucial link between design, materials & installation
- Rooftop management tools to support operational requirements

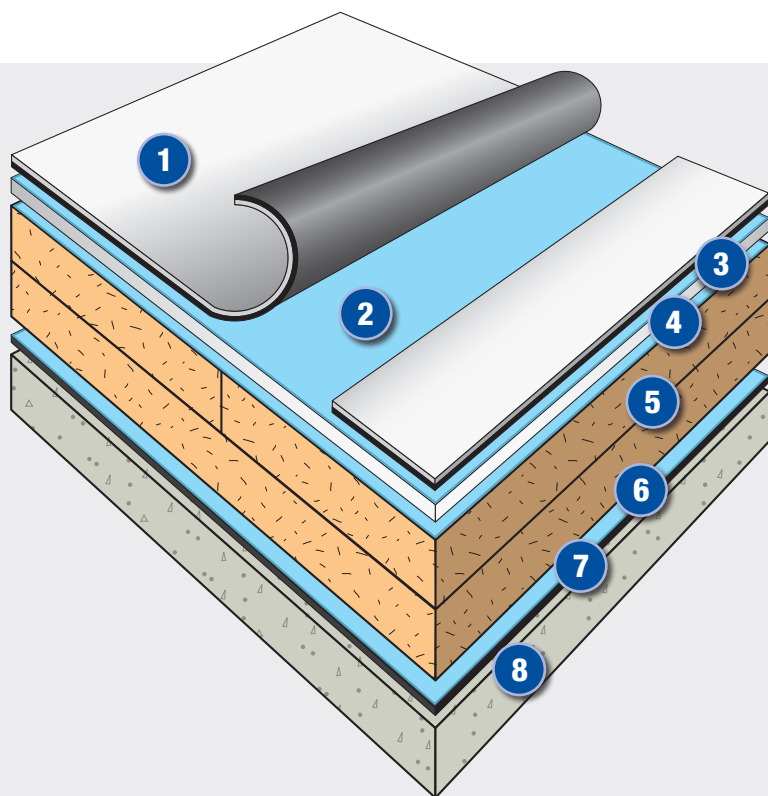

OPTIMAL ROOF ASSEMBLY

- 1 Reflective or Dark-colored Membrane (climate appropriate)
- 2 VOC- and Solvent-free Membrane Adhesive
- 3 Performance-enhancing Coverboard
- 4 VOC- and Solvent-free Coverboard Adhesive
- 5 Double Layer Insulation with Staggered Joints
- 6 VOC- and Solvent-free Insulation Adhesive
- 7 Air and Vapor Retarder (as required)
- 8 Approved Roof Deck

SPECIALIZED DESIGN FOR PROPERTY MANAGEMENT

Carlisle SynTec Systems understands that high-performance roofing systems for office buildings, shopping centers, and distribution facilities often require specialization. Our experience, breadth of products and system offerings position us as a leader in providing you with the solutions your facility needs.

Specialized Solutions

- Single-source warranty coverage for:
 - » Roof gardens
 - » Metal roofs
- Stormwater management systems
- Plaza deck & rooftop paver systems
- Skylights
- Non-penetrating recover applications
- Rooftop sound isolation assemblies



TOTAL ROOFING SYSTEMS SINGLE-SOURCE CAPABILITIES

- EPDM, TPO & PVC roofing membranes
- Polyiso, EPS & XPS insulations
- Fire- & thermal-resistant coverboards
- Adhesives & sealants
- Air & vapor retarders
- Metal edging, coping & accessories
- Roof gardens, plaza & rooftop paver systems
- Skylights & daylighting

ENERGY EFFICIENT SYSTEM DESIGN

A properly insulated and detailed roof system is key to optimizing energy efficiency and savings. Carlisle's RoofSense software reviews a building's energy costs and recommends the optimal roof color and insulation R-value to minimize energy costs. Carlisle offers a versatile line of high-performance roofing solutions customized for healthcare facilities in their specific regions.



ROOFING SYSTEM WARRANTIES

Carlisle SynTec understands that the long-term performance and protection delivered by a roofing system is a vitally important concern for any building. Carlisle offers warranties up to 30 years, which are available with coverage against accidental puncture, 120-mph winds and hail up to three inches in diameter. Facility owners and managers want to know that a strong, industry-leading manufacturer is standing behind their products. As a division of publicly traded Carlisle Companies (NYSE: CSL), Carlisle SynTec Systems has a warranty reserve that is audited annually to ensure its sufficiency.