

NOTES:

1. RhinoBond METHOD OF MEMBRANE ATTACHMENT IS NOT FOR USE WITH NON-FACED EPS (EXPANDED POLYSTYRENE) OR XPS (EXTRUDED POLYSTYRENE) INSULATIONS.
2. PERIMETER ENHANCEMENTS REQUIRED FOR WIND SPEED COVERAGE GREATER THAN 72MPH. CONTACT CARLISLE FOR REQUIREMENTS.
3. ENHANCEMENTS SHOWN ARE FOR THE PURPOSE OF THE CARLISLE WARRANTY. FOR FM PROJECTS CONSULT FM GLOBAL FOR REQUIRED ENHANCEMENTS.

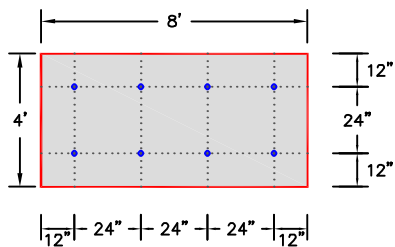

(A) PERIMETER ZONE
8 FASTENERS PER 4'X8' BOARD

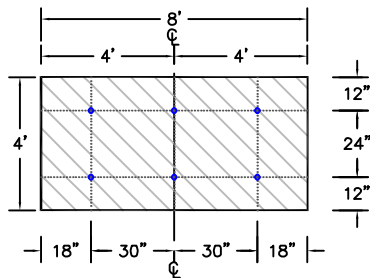

(B) FIELD OF ROOF
6 FASTENERS PER 4'X8' BOARD

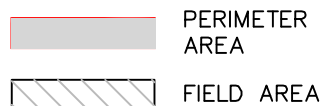

● CARLISLE FASTENER & RhinoBond FASTENER PLATE

RAISED ROOF EDGE OR PARAPET WALL

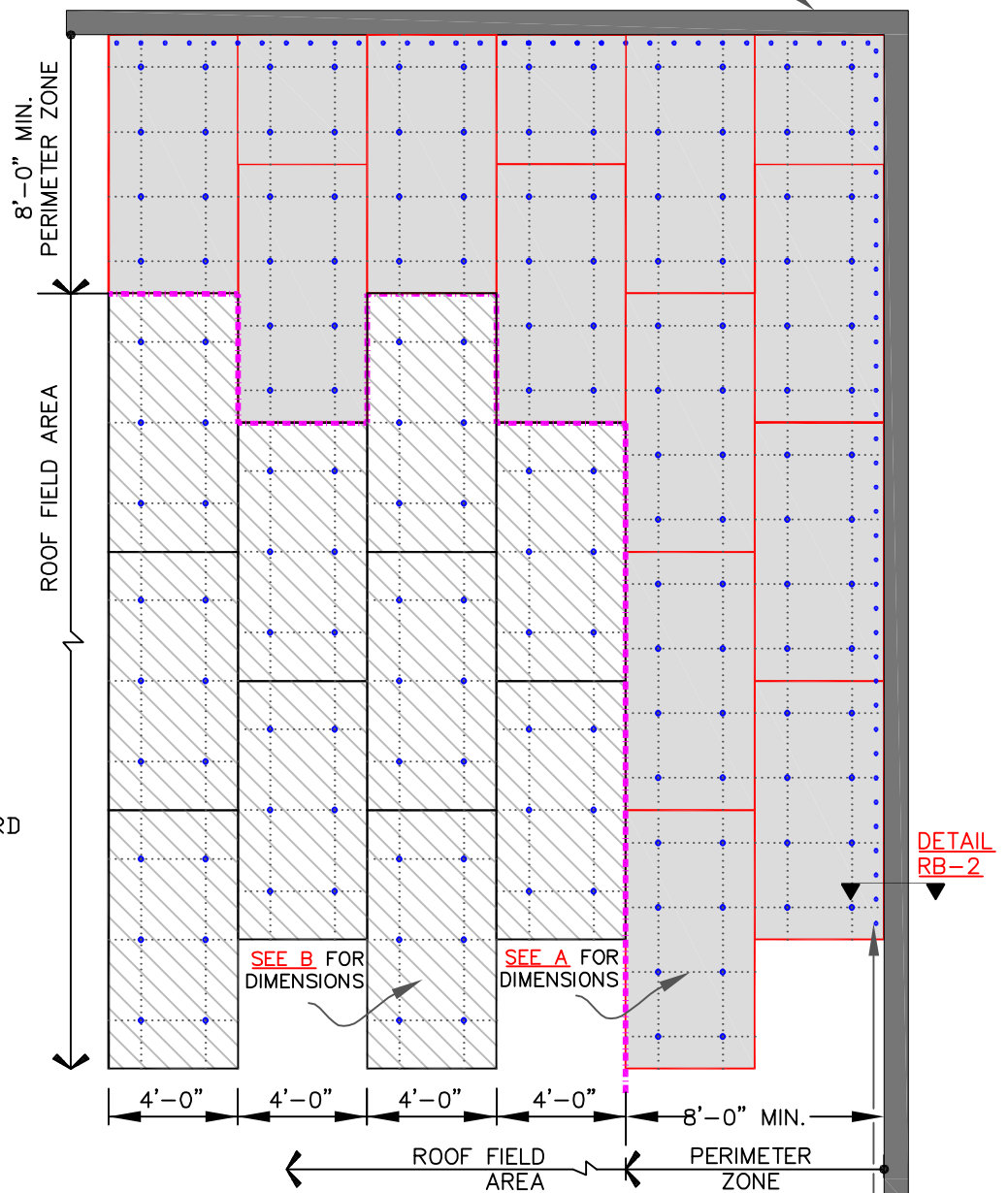

MEMBRANE FASTENED MINIMUM 12" O.C. AT ANGLE(S) CHANGES. FOR ADDITIONAL INFORMATION SEE DETAIL RB-2

DECK TYPE	DECK THICKNESS	FASTENER	THERMOPLASTIC COATED PLATE
STEEL	22 GAUGE(0.8mm)	CARLISLE HP-X FASTENER	3-1/8" (8cm) DIAMETER
PLYWOOD	15/32" (12mm)		

NOTE: AT IN-FILL MINOR PIECES, USE MIN. 2 FASTENERS.

INCHES TO CENTIMETERS							
inch	2"	3.5"	4"	12"	18"	24"	30"
cm	5	9	10	30	46	61	76

FEET TO CENTIMETERS			
FEET	1'	4'	8'
cm	30	120	250

— THERMOPLASTIC MEMBRANE — APPROVED SUBSTRATE — SEE NOTE(S)	RhinoBond ATTACHMENT METHOD — NUMBER OF FASTENERS AND LOCATIONS For additional information, refer to Specifications		DETAIL NO. RB-1 RhinoBond
---	--	--	--