

NOTES:

1. REFER TO [VERSITRIM SNAP-ON CANTED FASCIA INSTRUCTION MANUAL](#) FOR STEP-BY-STEP INSTALLATION PROCEDURES.
2. WHEN METAL FASCIA BY OTHERS IS USED, FASTENER TYPE AND FASTENING FREQUENCY SHALL BE RECOMMENDED BY METAL EDGE MANUFACTURER.

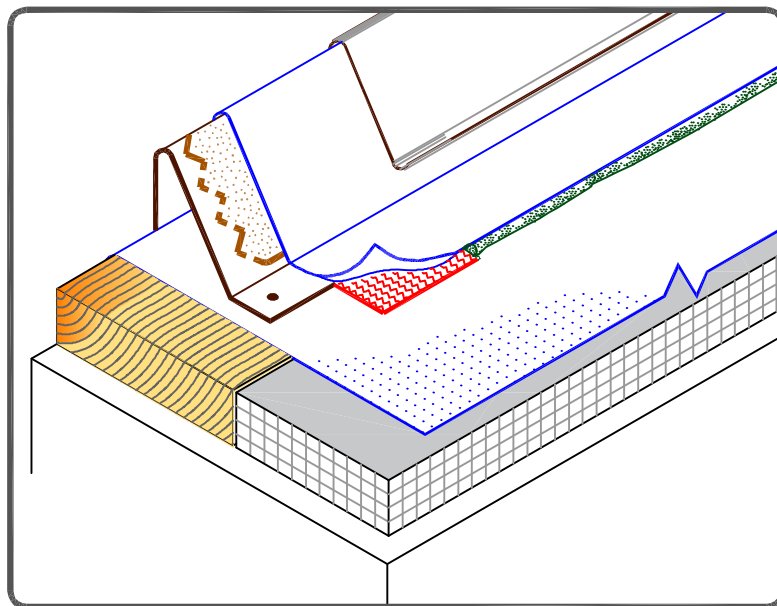

VERSITRIM SNAP-ON
CANTED FASCIA

MAXIMUM WARRANTY: 30 YEARS

— TPO MEMBRANE
— APPROVED SUBSTRATE
0 — SEE NOTE

PS (PRESSURE SENSITIVE)
P&S (PEEL & STICK)
QA (QUICK APPLIED)

THERMOPLASTIC
ROOFING SYSTEM

TPC-1.4